



# UtiliView

Application

# Operator's Manual



# Overview

## Intended Use

The Subsite UtiliView mapping app is intended to be used in utility mapping applications. The app provides the user with the ability to send log points from the receiver to the user's Esri® map, including support for both Esri and ArcGIS® Online and Esri ArcGIS Enterprise deployments. Attributes such as utility type, depth, and frequency are tied to each log point. A line between each log point is created with the distance between points also calculated. The app also has a feature called Point Navigation that allows a user to enter a previously located log point ID and navigate back to it.

The UtiliView app can be used with the Subsite® Utiliguard 2 RTK receivers with GNSS capabilities.

The UtiliView app should be operated only by persons familiar with its particular characteristics and acquainted with the relevant safety procedures.

## California Proposition 65



**WARNING**

Cancer, birth defects, and other reproductive harm. [www.P65warnings.ca.gov](http://www.P65warnings.ca.gov).



---

# Foreword

This manual is an important part of your equipment. It provides safety information and operation instructions to help maintain your Subsite equipment.

Read this manual before using your equipment. Keep it with the equipment at all times for future reference. If you sell your equipment, be sure to give this manual to the new owner.

If you need a replacement copy, contact your Ditch Witch dealer. If you need assistance in locating a dealer, visit our website at [www.subsite.com](http://www.subsite.com), email [info@subsite.com](mailto:info@subsite.com) or write to the following address:

Subsite Electronics  
ATTN: Product Support  
1950 W. Fir  
Perry, OK 73077-0066  
USA

The descriptions and specifications in this manual are subject to change without notice. The Charles Machine Works, Inc. reserves the right to improve equipment. Some product improvements may have taken place after this manual was published. For the latest information on Subsite equipment, see your Ditch Witch dealer.

Thank you for buying and using Subsite equipment.

**UtiliView App  
Operator's Manual**

**Issue number 2.0/OM-02/2026**

**Part number 790-10007**

**Copyright 2024, 2026**

**by The Charles Machine Works, Inc.**



Subsite and Ditch Witch are registered trademarks of The Charles Machine Works, Inc.

This product and its use may be covered by one or more patents at <http://patents.charlesmachine.works>.

---

# Contents

<b>Overview</b>	<b>1</b>
Equipment serial number, information about the type of work this equipment is designed to perform, basic equipment components, and how to use this manual	
<b>Foreword</b>	<b>3</b>
Part number, revision level, and publication date of this manual, and factory contact information	
<b>Safety</b>	<b>7</b>
Equipment safety alerts and emergency procedures	
<b>Prepare</b>	<b>11</b>
Procedures for preparing jobsite, preparing operator, and preparing equipment	
<b>Controls</b>	<b>19</b>
Equipment controls and indicators and how to use them	
<b>System Operation</b>	<b>35</b>
Procedures for using the app	
<b>Support</b>	<b>45</b>
The warranty policy for this equipment and procedures for obtaining warranty consideration and training	

---



---

# Safety

## Chapter Contents

**Safety Alert Classifications . . . . . 8**

**Guidelines . . . . . 9**

**Safety Alerts . . . . . 10**

## Safety Alert Classifications

These classifications and the icons defined on the following pages work together to alert you to situations which could be harmful to you, jobsite bystanders, or your equipment. When you see these words and icons in the book or on the machine, carefully read and follow all instructions. **YOUR SAFETY IS AT STAKE.**



When you see this safety alert sign, carefully read and follow all instructions. **YOUR SAFETY IS AT STAKE.** Read this entire section before using your equipment.

Watch for the three safety alert levels: **DANGER**, **WARNING**, and **CAUTION**. Learn what each level means.



**DANGER** indicates a hazardous situation that, if not avoided, will result in death or serious injury. This signal word is to be limited to the most extreme situations.



**WARNING** indicates a hazardous situation that, if not avoided, could result in death or serious injury.



**CAUTION** indicates a hazardous situation that, if not avoided, could result in minor or moderate injury.

Watch for two other words: **NOTICE** and **IMPORTANT**.

**NOTICE** indicates information considered important, but not hazard-related (e.g., messages relating to property damage).

**IMPORTANT** can help you do a better job or make your job easier in some way.

## Guidelines

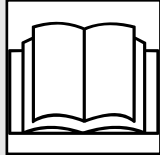

**⚠ WARNING**

Misuse of equipment can cause death or serious injury. Read and understand operator's manual and all other safety instructions before use.

Follow these guidelines before operating any jobsite equipment:

- Complete proper training.
- Read and understand operator's manual before using equipment.
- Wear personal protective equipment.
- Do not operate the equipment when you are tired, ill, or under the influence of alcohol or drugs.
- In the US or Canada, call 811 (US) or 888-258-0808 (US and Canada). Also contact any local utilities that do not participate in the One-Call service. In countries that do not have a One-Call service, contact all local utility companies to have underground utilities located.
- Classify jobsite based on its hazards and use correct tools and machinery, safety equipment, and work methods for jobsite.
- Mark jobsite clearly and keep spectators away.
- Review jobsite hazards, safety and emergency procedures, and individual responsibilities with all personnel before work begins.
- Fully inspect equipment before operating. Repair or replace any worn or damaged parts. Replace missing or damaged safety shields and safety alert signs. Contact your Ditch Witch dealer for assistance.
- Replace missing or damaged safety signs.
- Use equipment carefully per the instructions in this manual. Stop operation and investigate anything that does not look or feel right.
- Contact your equipment dealer if you have any questions about operation, maintenance, or equipment use.

## Safety Alerts

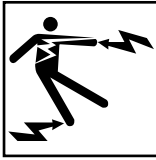

**⚠ DANGER** Electrical equipment. Contact will cause death or serious injury. Read and understand operator's manual. Know emergency procedures.

**To help avoid injury:**

- Check that equipment is in good condition and that test leads are clean and have no cracked insulation.
- Only connect transmitter to live utility when using live power adapter.



**⚠ WARNING** Lithium cell batteries. Fire or explosion can cause death or serious injury. Follow proper care, handling, and charging precautions. See operator's manual.

**To help avoid injury:**

- Turn off equipment and remove accessories before opening battery compartment.
- Only charge with approved battery charger.
- Do not crush, heat or incinerate, short circuit, dismantle, or immerse in fluid.
- Use proper disposal.
- Follow proper shipping procedures for Class 9 batteries.

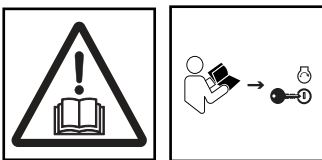

**⚠ WARNING** Misuse of equipment can cause death or serious injury. Read and understand operator's manual and all other safety instructions before use.

**To help avoid injury:** Only operate away from explosive devices or blasting operations.



**⚠ WARNING** Moving traffic - hazardous situation. Death or serious injury could result. Avoid moving vehicles, wear high-visibility clothing, post appropriate warning signs.



**⚠ CAUTION** Hot batteries. Contact can cause injury. Only touch when cool or wear gloves.

# Prepare

## Chapter Contents

	<p>See "Safety" for additional precautions.</p> <p>Wear proper personal protective equipment.</p>
---	---

### **Prepare Jobsite . . . . . 12**

- Review Job Plan . . . . . 12
- Select Start and End Points . . . . . 12
- Identify Hazards . . . . . 13
- Locate Utilities . . . . . 13
- Classify Jobsite . . . . . 14
- Arrange for Traffic Control . . . . . 15

### **Prepare Operator . . . . . 16**

### **System Requirements . . . . . 17**

- Esri . . . . . 17
- Locating . . . . . 17
- Point Navigation GNSS . . . . . 17

## Prepare Jobsite



**⚠ WARNING**

Underground utilities. Contact can cause death or serious injury. Locate and verify underground utilities before digging or drilling.

**To help avoid injury:**

- Expose lines by careful hand digging or soft excavation before operating equipment. Use appropriate equipment and procedures for exposing utility lines.
- Classify jobsite and follow precautions based on classification.
- Follow local regulations for digging near utilities.

A successful job begins before working. The first step in planning is reviewing information already available about the job and jobsite.

### Review Job Plan

Review blueprints or other plans. Check for information about existing or planned structures, elevations, or proposed work that may be taking place at the same time.

### Select Start and End Points

Select one end to use as a starting point. Consider the following when selecting a starting point:

#### Slope

Equipment should be parked on a level site. Consider how slope will affect setup and operation. Assess the risks on each slope to determine if factors affecting risks create an unsafe condition for working.

#### Space

Check that starting and ending points allow enough space for working.

#### Comfort

Consider shade, wind, fumes, and other site features.

## Identify Hazards

Inspect jobsite before transporting equipment. Check for the following:

- overall grade or slope
- changes in elevation such as hills or open trenches
- obstacles such as buildings, railroad crossings, or streams
- signs of utilities
  - “buried utility” notices
  - gas or water meters
  - drop boxes
  - manhole covers
  - utility facilities without overhead lines
  - junction boxes
  - light poles
  - sunken ground
- traffic
- access
- soil type and condition
- loose material such as fencing or cable

## Locate Utilities

### Notify One-Call Services

Mark proposed path with white paint and have underground utilities located before working.

- In the US or Canada, call 811 (US) or 888-258-0808 (US and Canada). Also contact any local utilities that do not participate in the One-Call service.
- In countries that do not have a One-Call service, contact all local utility companies to have underground utilities located.

### Verify Underground Utilities

Have an experienced locating equipment operator sweep area within 20’ (6 m) to each side of proposed excavation to verify previously marked line and cable locations. Mark location of all buried utilities and obstructions.

### Locate Overhead Lines

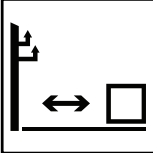
**⚠ DANGER** Overhead electrical lines. Contact will cause death or serious injury. Know location of lines. Stay away.

Note location and height of all overhead lines in jobsite and ensure that equipment maintains proper distance from live lines.

## Classify Jobsite

### Select a Classification

Jobsites are classified according to underground hazards present, not by line being installed. Jobsite may have more than one classification.

If working . . .	then classify jobsite as . . .
within 10' (3m) of a buried electric line	electric
within 10' (3m) of a natural gas line	natural gas
in concrete, sand, or granite which is capable of producing crystalline silica dust	crystalline silica dust
within 10' (3m) of any other hazard	other

Classify jobsite as electric if jobsite is in question or if the possibility of unmarked electric utilities exists.

### Apply Precautions

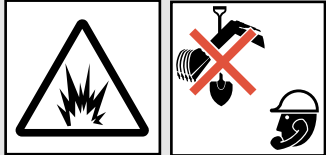

**⚠ WARNING** Underground utilities. Contact can cause death or serious injury. Locate and verify underground utilities before digging or drilling.

Once classified, precautions appropriate for jobsite must be taken. Follow US Department of Labor regulations on excavating and trenching (Part 1926, Subpart P) and other similar regulations.

#### Electric Jobsite Precautions

Use one or both of these methods:

- Expose line by careful hand digging or soft excavation.
- Have service shut down while work is in progress. Have electric company test lines before returning them to service.

#### Natural Gas Jobsite Precautions

Position equipment upwind from gas lines and use one or both of these methods:

- Expose line by careful hand digging or soft excavation.
- Have service shut down while work is in progress. Have gas company test lines before returning them to service.

---

**Crystalline Dust Jobsite Precautions**



**⚠ WARNING** Silica dust. Exposure can cause lung disease or cancer.  
Use breathing protection.

Crystalline silica dust is a naturally occurring substance found in soil, sand, concrete, granite, and quartz.

To reduce exposure when cutting, drilling, or working these materials:

- Use water spray or other means to control dust.
- Refer to US Occupational Safety and Health Administration (OSHA) guidelines or other applicable regulating guidelines for appropriate breathing protection or dust control methods.

**Other Jobsite Precautions**

You may need to use different methods to safely avoid other underground hazards. Talk with those knowledgeable about hazards present at each site to determine which precautions should be taken or if job should be attempted.

Clear objects such as landscaping fabric, cable, and wire from the work area. These objects may be underground or partially buried.

**Arrange for Traffic Control**

Vehicle and pedestrian traffic must be a safe distance from equipment. Evaluate jobsite and allow an appropriate buffer zone around equipment. If working near a road or other traffic area, contact local authorities about safety procedures and regulations.

## Prepare Operator



**⚠ WARNING** Jobsite hazards. Exposure can cause death or serious injury. Use correct equipment and work methods. Use and maintain appropriate safety equipment.

**To help avoid injury:**

- Wear personal protective equipment including hard hat, safety eye wear, foot protection, hearing protection, and gloves (except when near rotating equipment).
- Remove jewelry.
- Wear close-fitting, high visibility clothing.
- Have other personal protective equipment, such as insulated boots and gloves, breathing protection, and face shield, etc. available for use depending on jobsite hazards or requirements.

Follow these guidelines before operating any jobsite equipment:

- Complete proper training and read operator's manual before using equipment.
- Plan for emergency services. Have the telephone numbers for local emergency and medical facilities on hand. Check that you will have access to a telephone.
- Review jobsite hazards, safety and emergency procedures, and individual responsibilities with all personnel before work begins. Safety videos are available from your Ditch Witch dealer or at [www.ditchwitch.com/safety](http://www.ditchwitch.com/safety). Safety Data Sheets (SDS) are available at [www.ditchwitch.com/support](http://www.ditchwitch.com/support).
- Use equipment carefully. Stop operation and investigate anything that does not look or feel right.

# System Requirements

## Operating System

UtiliView requires the following system or higher: iOS 14 or Android 6.

## Esri®

An Esri account with access to ArcGIS® Pro is required. The UtiliView application supports integration with Esri ArcGIS Online and Esri ArcGIS Enterprise environments. The application has been tested with ArcGIS Pro version 3.5.3 or later and compatible ArcGIS Online and ArcGIS Enterprise releases. Earlier versions may not be supported.

## Locating

A UtiliGuard 2 RTK must be used to log points and lines.

## Point Navigation GNSS

**IMPORTANT:** GNSS accuracy depends on the accuracy of the device being used. See GNSS device specifications to determine accuracy.

Point Navigation can be used with or without a UtiliGuard 2 receiver. If a UtiliGuard 2 receiver is paired to the smart device, Point Navigation will use the higher accuracy GNSS antenna and corrections service, if applicable. If a UtiliGuard 2 receiver is not paired to the mobile device, the mobile device can use its native GNSS antenna.



---

# Controls

## Chapter Contents

<b>Maps Menu</b> .....	<b>20</b>
<b>Swipe Options and New Map</b> .....	<b>21</b>
<b>Settings Menu</b> .....	<b>22</b>
<b>Tabs</b> .....	<b>24</b>
<b>Map</b> .....	<b>26</b>
<b>Attachment</b> .....	<b>28</b>
<b>Point Navigation</b> .....	<b>29</b>
<b>Correction Services</b> .....	<b>31</b>
<b>Swipe Options and New Service</b> .....	<b>32</b>
<b>Corrections</b> .....	<b>33</b>
<b>Connected Device</b> .....	<b>34</b>

# Maps Menu



- 1. Settings
- 2. Esri maps

- 3. New Esri map

Item	Description	IMPORTANT
1. Settings	To access general settings, press.	
2. Esri maps	List of existing Esri maps.	
3. New Esri map	To set up a new Esri map, press.	

# Swipe Options and New Map

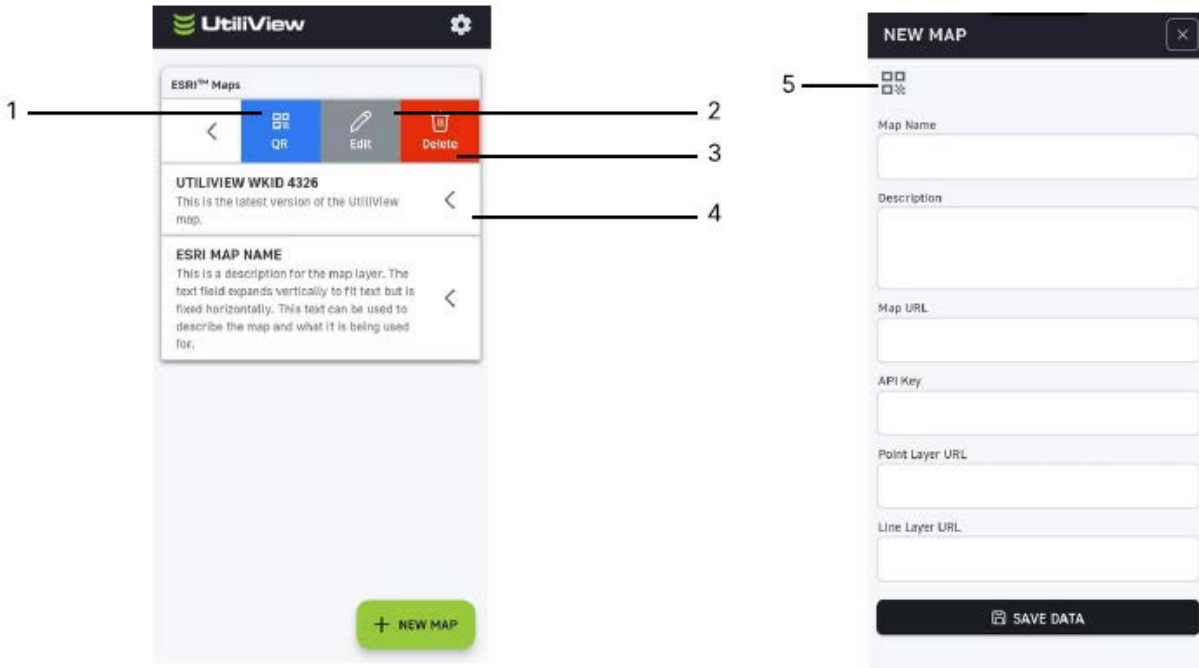

- 1. QR display
- 2. Edit
- 3. Delete
- 4. Swipe
- 5. QR scan

Item	Description	IMPORTANT
1. QR display	To view QR code to share the map, press.	
2. Edit	To edit the map, press.	
3. Delete	To delete the map from this device, press.	
4. Swipe	To see details about a job, swipe left.	
5. QR scan	To enter another map's data, press.	

# Settings Menu

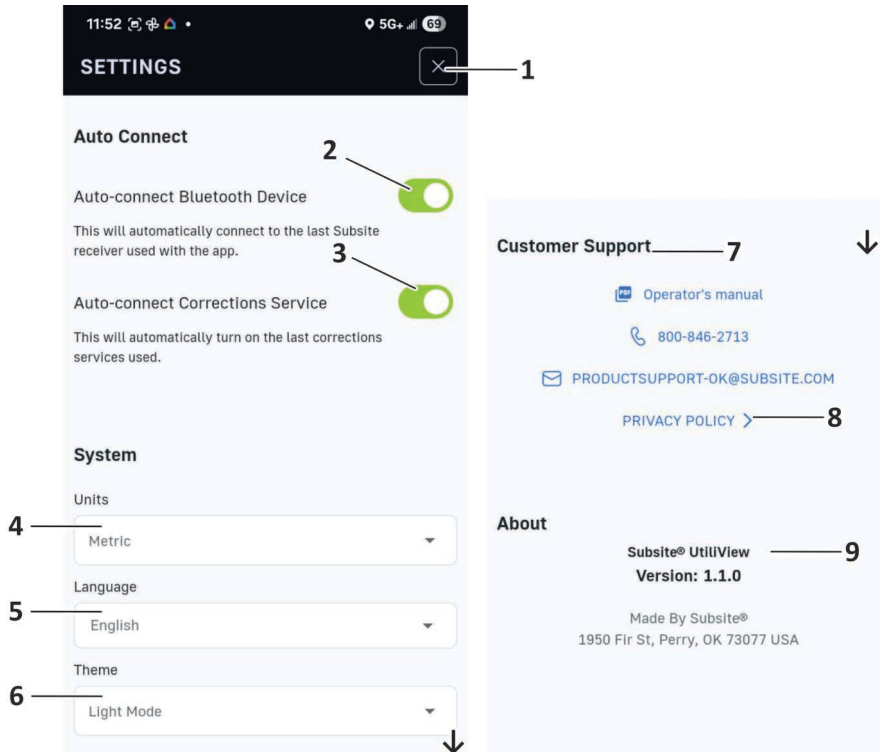

- 1. Close
- 2. Auto-connect Bluetooth® device
- 3. Auto-connect corrections service
- 4. Units
- 5. Language
- 6. Theme
- 7. Customer support information
- 8. Privacy Policy
- 9. Version

Item	Description	IMPORTANT
1. Close	To close settings and return to the layer menu, press.	
2. Auto-connect Bluetooth® device	To enable device to automatically connect to the most recent receiver used with the apple, toggle on.	
3. Auto-connect corrections service	To enable app to automatically turn on most recent corrections service used, toggle on.	

<b>Item</b>	<b>Description</b>	<b>IMPORTANT</b>
<b>4. Units</b>	To change display units, press.	
<b>5. Language</b>	To change language, press.	
<b>6. Theme</b>	To change the theme, press.	Options are Dark, Light, or System.
<b>7. Customer support information</b>	Displays link to operator's manual, and phone number and email for support.	
<b>8. Privacy policy</b>	To see our privacy policy, press.	
<b>9. Version</b>	Displays the version of the application.	

# Tabs

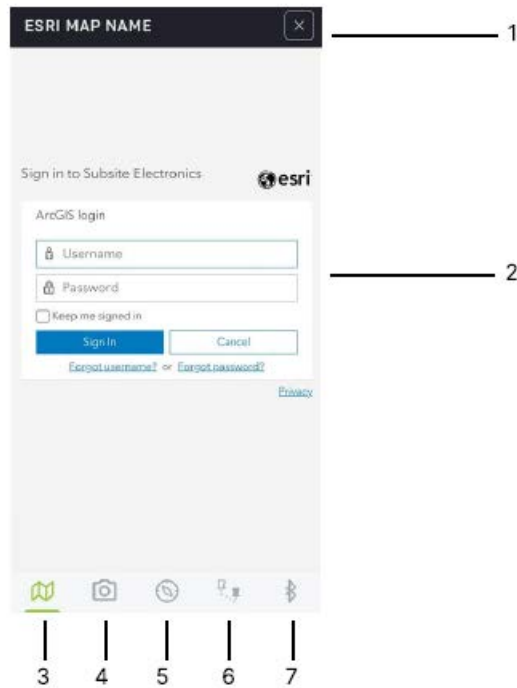

- 1. Close
- 2. Esri map web view
- 3. Map
- 4. Attachment
- 5. Point Navigation
- 6. Correction services
- 7. Connections

Item	Description	IMPORTANT
<b>1. Close</b>	To close Esri map and return to the map menu, press.	
<b>2. Esri map web view</b>	To open web view for Esri map, press and enter Esri credentials.	
<b>3. Map</b>	To display the Esri map, press.	
<b>4. Attachment</b>	To attach an image to a log point, press and enter the point ID.	
<b>5. Point Navigation</b>	To navigate back to a log point, press and enter the point ID.	

---

<b>Item</b>	<b>Description</b>	<b>IMPORTANT</b>
<b>6. Correction services</b>	To set up and connect to a correction service, press.	
<b>7. Connections</b>	To connect to a UtiliGuard receiver, press.	

---

# Map

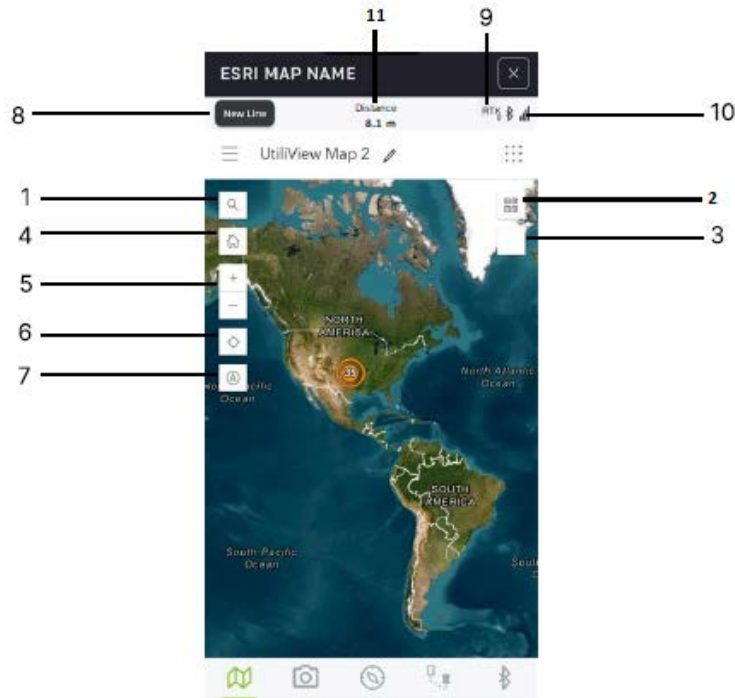

- 1. Search
- 2. Basemap options
- 3. Layer list
- 4. Home
- 5. Zoom
- 6. Current location
- 7. Auto-refresh location
- 8. New line
- 9. Corrections count
- 10. Bluetooth signal strength
- 11. Distance from last point

Item	Description	IMPORTANT
1. Search	To search for locations within Esri, press.	
2. Basemap options	To change the style of the basemap, press.	
3. Layer list	To change visibility of layers, press.	
4. Home	To return to the default view, press.	
5. Zoom	To zoom in or out, press.	

Item	Description	IMPORTANT
6. <b>Current location</b>	To display the current location of the device, press.	
7. <b>Auto-refresh location</b>	To updates current location every second, press. To stop automatic location updates, press again.	
8. <b>New line</b>	To end current line and start a new one, press.	
9. <b>Corrections count</b>	Displays NTRIP RTK corrections packet count.	
10. <b>Bluetooth signal strength</b>	Indicates the strength of the Bluetooth connection.	
11. <b>Distance from last point</b>	Displays distance traveled from last point.	

# Attachment



1. Log point ID field

2. Attach image

Item	Description	IMPORTANT
1. Log point ID field	To find a log point on the map, enter log point ID.	
2. Attach image	To attach a photo or image from the library, press.	

# Point Navigation

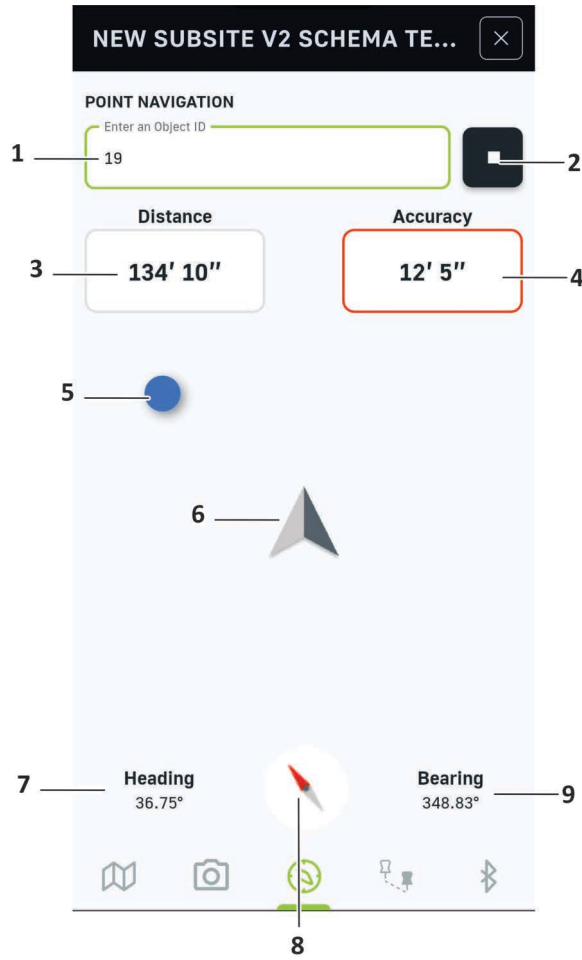

- 1. Log point ID field
- 2. Start/Stop
- 3. Distance
- 4. Accuracy
- 5. Log point
- 6. Device position
- 7. Heading
- 8. Compass
- 9. Bearing

Item	Description	IMPORTANT
1. Log point ID field	To find a log point on the map, enter log point ID.	
2. Start/Stop	To begin and end navigation, press.	
3. Distance	Displays distance to log point.	
4. Accuracy	Displays GNSS accuracy.	

---

<b>Item</b>	<b>Description</b>	<b>IMPORTANT</b>
<b>5. Log point</b>	Indicates log point destination.	
<b>6. Device position</b>	Represents device position.	
<b>7. Heading</b>	Displays the compass direction the Android or iOS device is pointing.	
<b>8. Compass</b>	Displays the cardinal directions and points North.	
<b>9. Bearing</b>	Displays the angle from North to the log point.	

# Correction Services

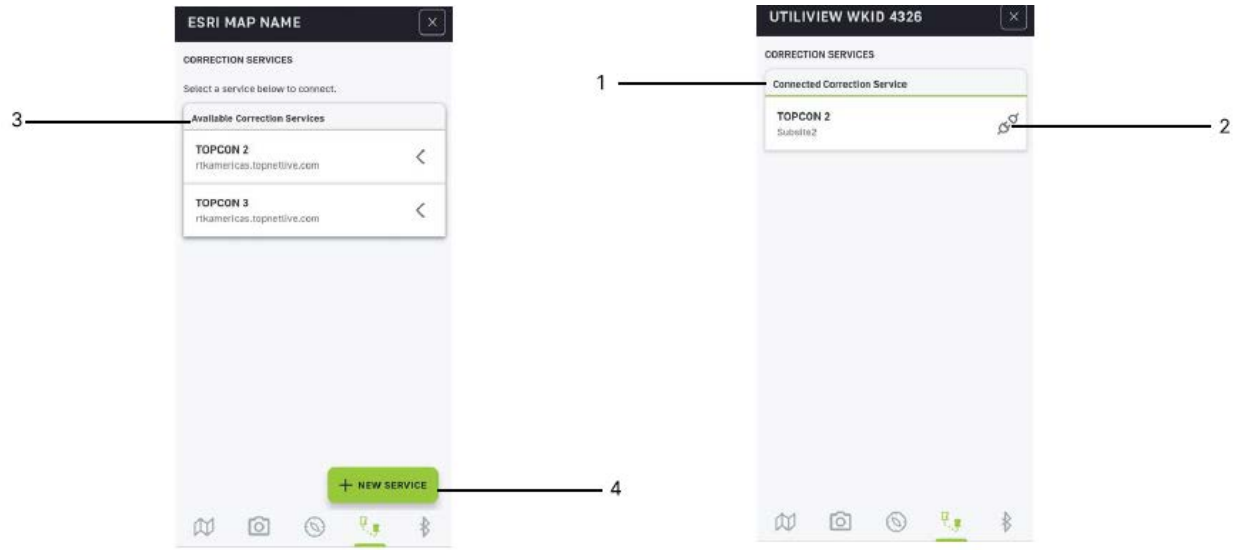

- 1. Connected correction service
- 2. Disconnect corrections service
- 3. Available correction services
- 4. New corrections service

Item	Description	IMPORTANT
1. <b>Connected correction service</b>	Indicates the correction service currently connected.	
2. <b>Disconnect corrections service</b>	To disconnect service, press.	
3. <b>Available correction services</b>	Displays corrections services not being used.	
4. <b>New corrections service</b>	To add new corrections service, press.	

## Swipe Options and New Service

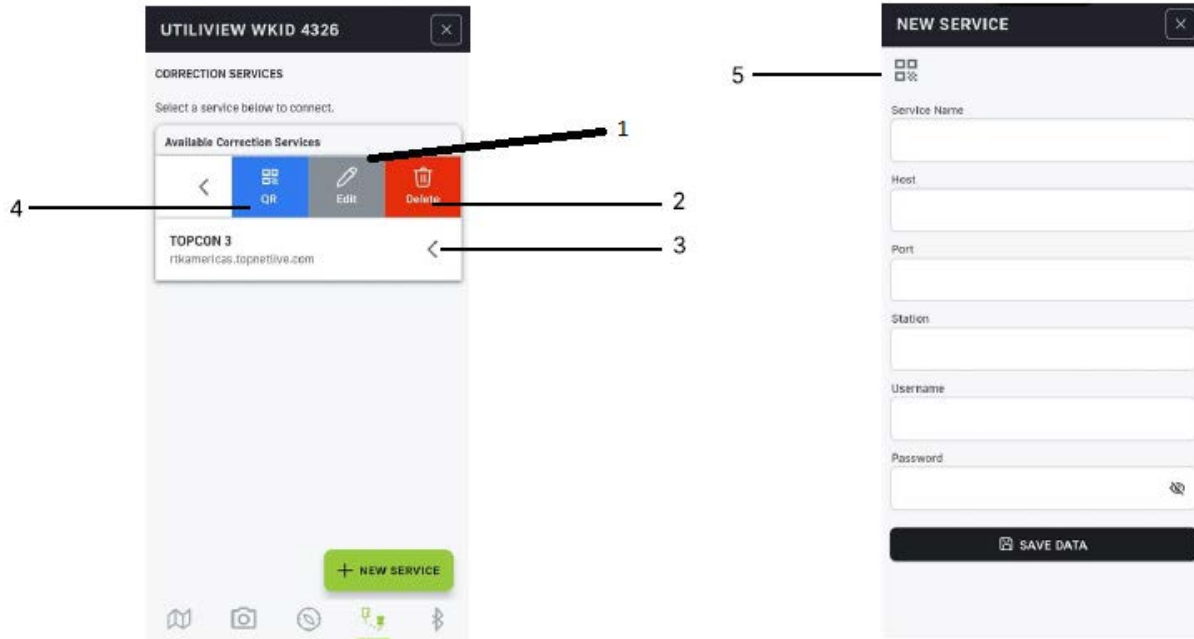

- |           |               |
|-----------|---------------|
| 1. Edit   | 4. QR display |
| 2. Delete | 5. QR scan    |
| 3. Swipe  |               |

Item	Description	IMPORTANT
1. Edit	To edit the corrections service, press.	
2. Delete	To delete the corrections service, press.	
3. Swipe	To see options, swipe left.	
4. QR display	To view QR code to share the service data, press.	
5. QR scan	To enter another service's data, press.	

# Connections

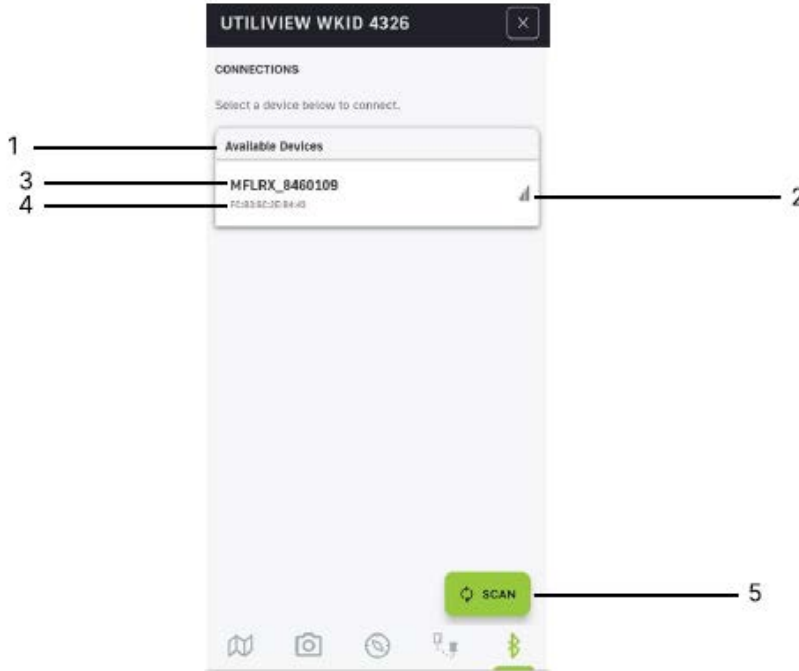

- 1. Available devices
- 2. Bluetooth signal strength
- 3. Device name
- 4. Device MAC address
- 5. Scan

Item	Description	IMPORTANT
1. Available devices	Available Bluetooth devices.	
2. Bluetooth signal strength	Displays signal strength of the Bluetooth device.	
3. Device name	Displays the name of the Bluetooth device.	
4. Device MAC address	Displays the unique MAC address of the Bluetooth device.	
5. Scan	To rescan for Bluetooth devices, press.	

## Connected Device



1. Connected device information

2. Disconnect service

Item	Description	IMPORTANT
1. <b>Connected device information</b>	To view information about the connected Bluetooth device, press.	
2. <b>Disconnect device</b>	To disconnect the Bluetooth device, press.	

---

# Operate

## Chapter Contents



For additional precautions, see "Safety" chapter.

<b>Set Up Esri Map</b> .....	<b>36</b>
• Schemas .....	36
<b>System Operation</b> .....	<b>39</b>

## Set Up

For detailed set up instructions, go to <https://www.subsite.com/wp-content/uploads/2026/04/UtiliView-Template-Setup-v02.pdf>.

## Schemas

### Subsite Version 1 Schema Template

The version 1 schema template is compatible with older UtiliView maps. It is not intended for advanced numerical analysis or automated reporting workflows. All geographic coordinates in this template are stored using the WGS 84 (EPSG:4326) coordinate reference system.

#### Point Layer Schema

Field Name	Alias	Data Type
logDate	Date	String
logTime	Time	String
gpsLatitude	Latitude	String
gpsLongitude	Longitude	String
gpsElevation	Elevation	String
gpsAccuracy	Accuracy	String
gpsSatellites	Satellites	String
gpsQuality	Quality	String
gpsHdop	Hdop	String
locationUtility	Utility	String
locationDepth	Depth	String
locationFrequency	Frequency	String
locationGain	Gain	String
locationAntenna	Antenna	String
locationMode	Mode	String
locationSanity	Sanity	String

**Line Layer Schema**

Field Name	Alias	Data Type
locationDistance	Distance	String
locationUtility	Utility	String

**Subsite Version 2 Schema Template (Recommended)**

Use the version 2 schema template for new set ups because it allows for advanced numerical analysis and automated reporting workflows with Ersi. All geographic coordinates in this template are stored using the WGS 84 (EPSG:4326) coordinate reference system.

**Point Layer Schema**

Field Name	Alias	Data Type
logDateTime	Date	Date
gpsLatitude	Latitude (°)	Double
gpsLongitude	Longitude (°)	Double
gpsElevation	Elevation	Double
gpsElevationUnit	Elevation unit	String
gpsAccuracy	Accuracy	Double
gpsAccuracy unit	Accuracy unit	String
gpsSatellites	Satellites	Short
gpsQuality	Quality	String
gpsHdop	Hdop	Double
locationUtility	Utility	String
locationDepth	Depth	Double
locationDepthUnit	Depth unit	String
locationFrequency	Frequency (Hz)	Double
locationGain	Gain (dB)	Double
locationAntenna	Antenna	String
locationMode	Mode	String
locationSanity	Sanity	String
locationSerial	Serial Number	String

**Line Layer Schema**

<b>Field Name</b>	<b>Alias</b>	<b>Data Type</b>
locationDistance	Distance	Double
locationDistanceUnit	Distance unit	String
locationUtility	Utility	String

# System Operation

1. Click **NEW MAP**, then enter a name, description, and the Esri information from the Esri Map Setup. For initial setup on or first mobile device, share a secure setup document with the mobile device.

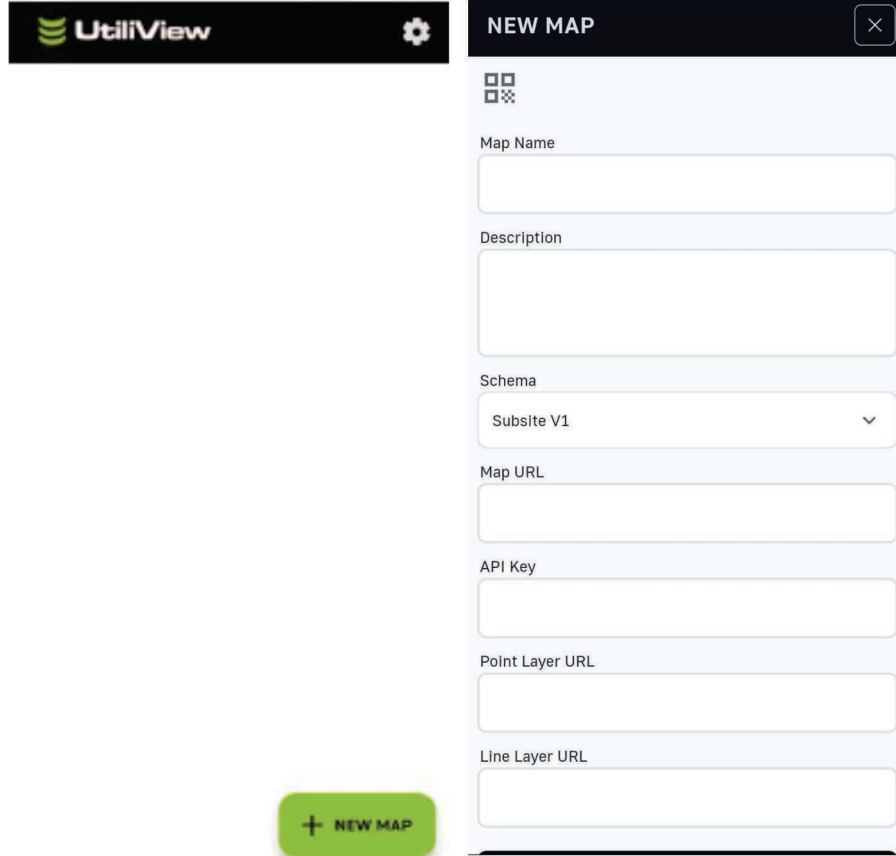

2. Click on the map you created to open it and then sign into your Esri account. Accept the location permission request.

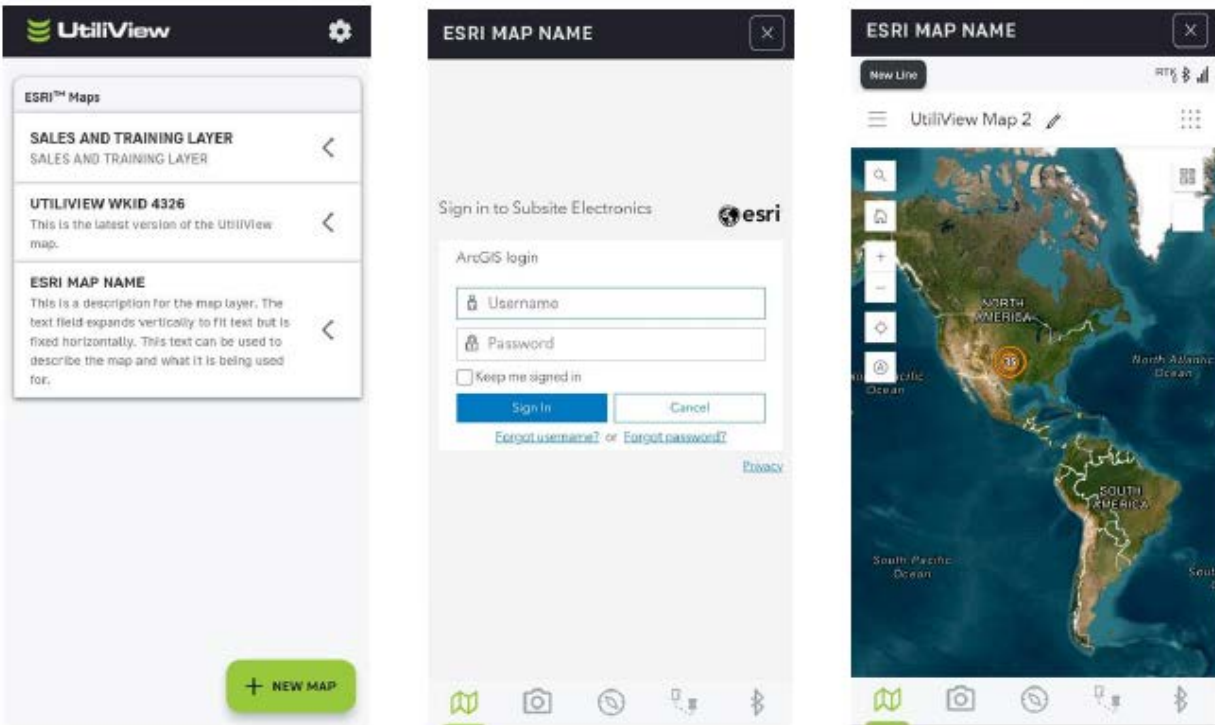

3. Click the Bluetooth tab, scan for your receiver, and then select it to connect. Accept the Bluetooth permission request.

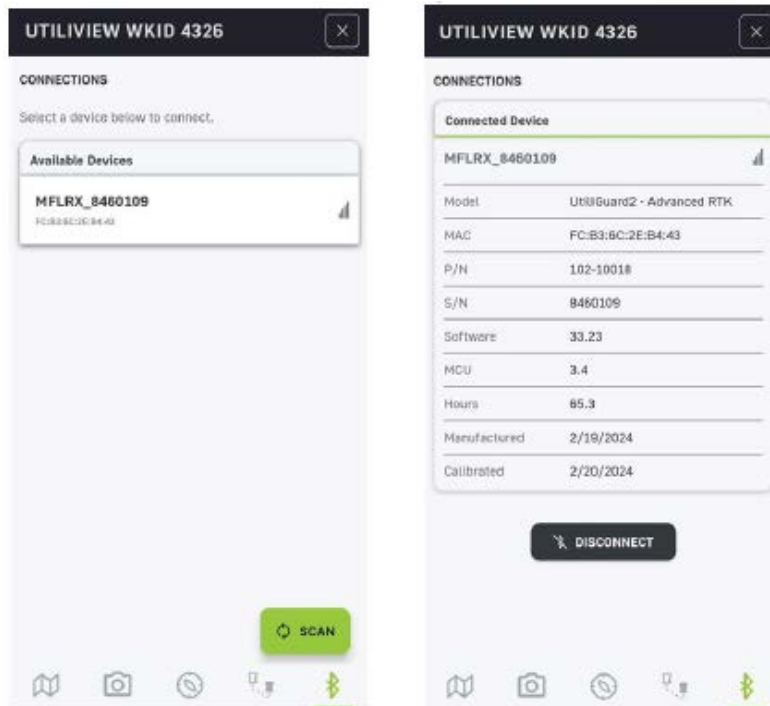

- If you are using a UTG2 RTK receiver and want to set up a corrections service for the highest accuracy, select the **Corrections** tab. Click **NEW SERVICE**, fill out the information from your service provider, click **save** and then select it from the list to connect.

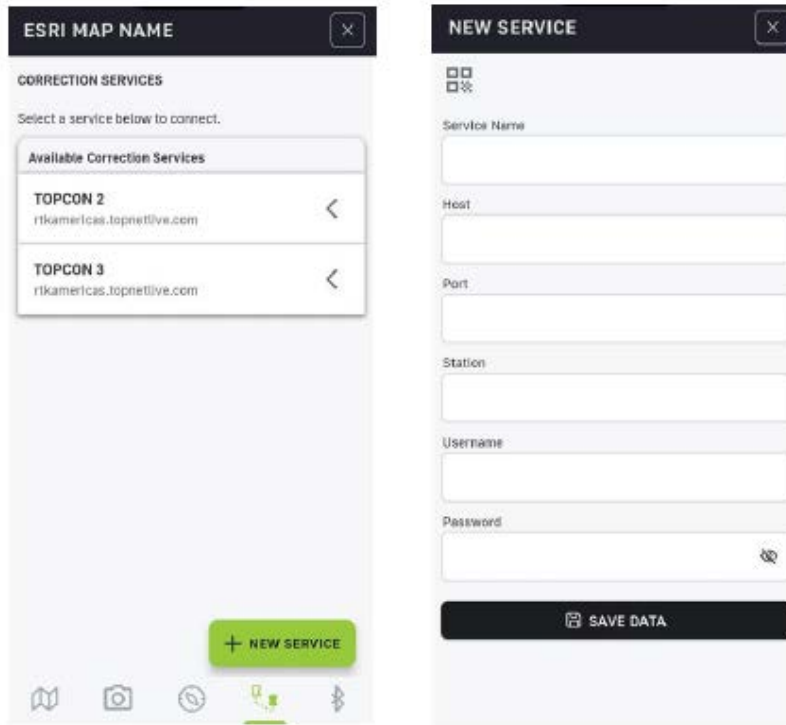

- When you log a point with the receiver, it will be sent to the Esri map automatically.



- If desired, attach a picture to a log point. Tap on the point in the Map tab to see its ID number. Enter that number on the Attachment tab and press the camera button.

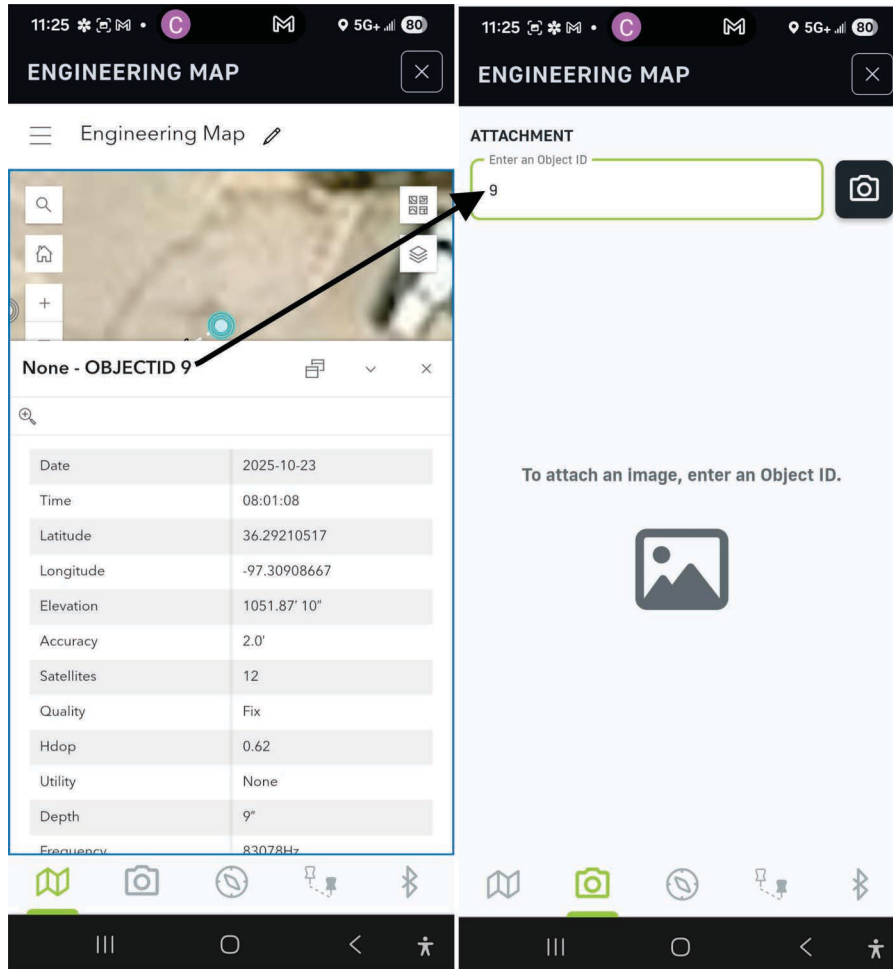

7. To find a log point again, press on it in the Map tab to see its ID number. Enter that number on the Point Navigation tab and press the start button to begin navigation.

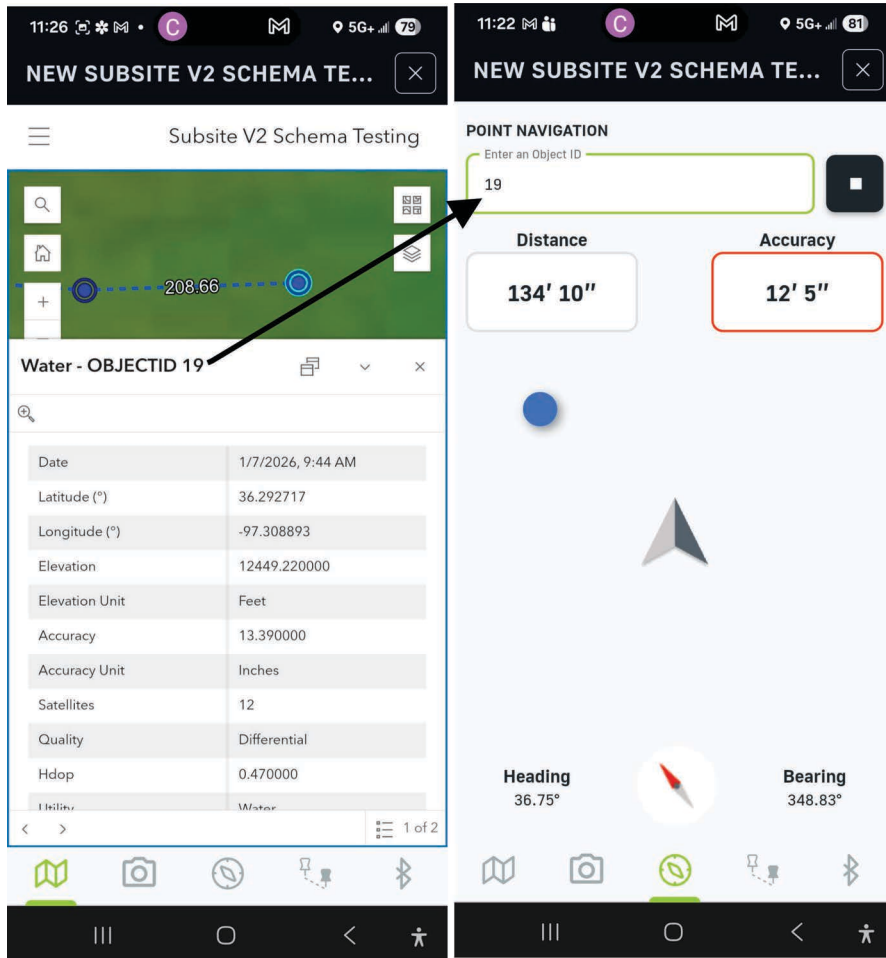



# Support

## Procedure

Notify your dealer immediately of any malfunction or failure of Subsite equipment.

Always give model, serial number, and approximate date of your equipment purchase. This information should be recorded and placed on file by the owner at the time of purchase.

Return damaged parts to dealer for inspection and warranty consideration if in warranty time frame.

All repairs must be done by an authorized Subsite repair facility. Repairs done elsewhere will void warranty.

## Resources

### Publications

Contact your dealer for publications and videos covering safety, operation, maintenance, and repair of your equipment.

### Training

For information about on-site individualized training, contact your dealer.