

## Bluetooth Setup

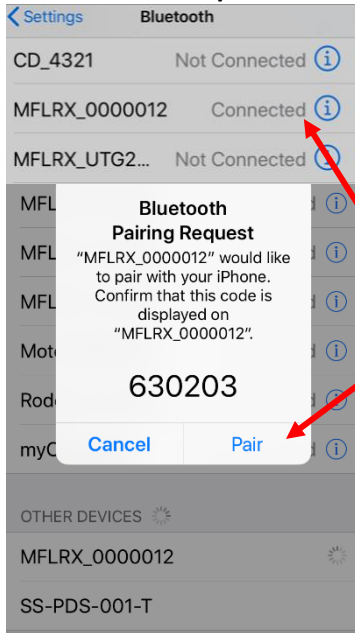

**Step 1** Turn on Bluetooth radio on the UtiliGuard receiver by going into **Menu-Configuration-Settings-Communications-Radio on/off**-select "on"

**Step 2** Open the Bluetooth Settings on your mobile device

**Step 3** Select your receiver i.e. ID name "MFLRX\_SerialNumber" and confirm the Bluetooth code on both the mobile device and receiver. *(The pairing request code appears the first time a mobile device is paired)*

630203

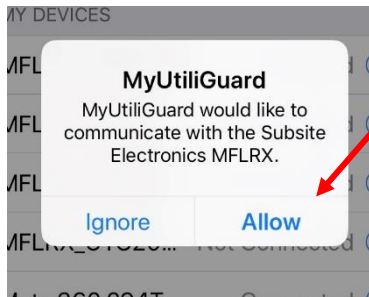
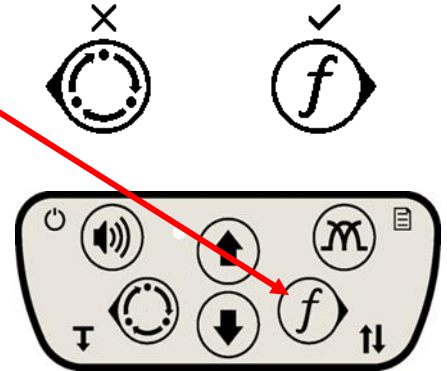

**Step 4** A pop up appears on the mobile device-click on the "Allow". The MyUtiliGuard app will open.

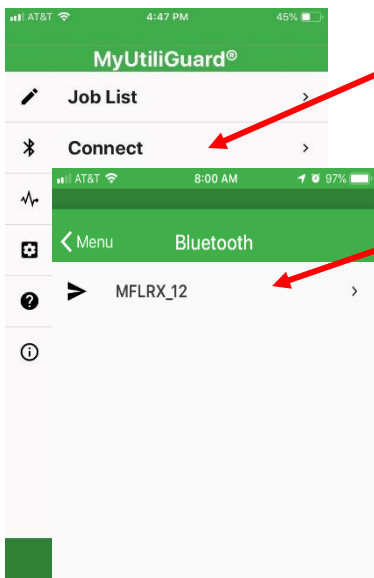

**Step 5** Select the "Connect" to proceed to the connection screen.

Select the UtiliGuard's Bluetooth ID

Once selected, user is prompted to setup logging

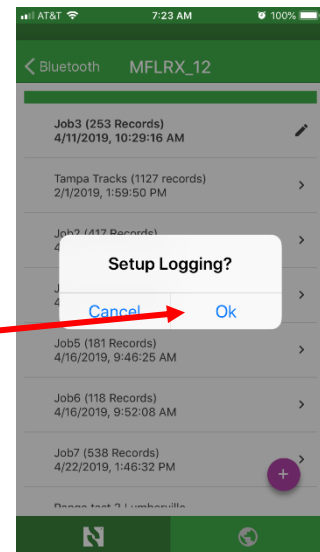



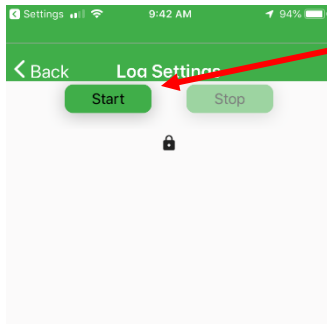

**Initialize logging**

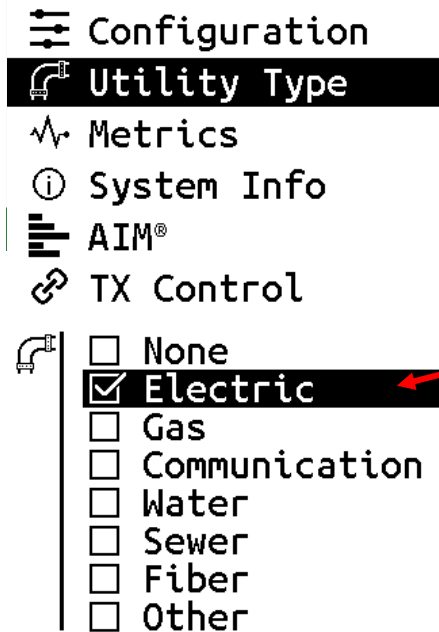

To initialize logging press the Start button.  
 Once the pin wheel starts spinning the user can start locating on the Receiver  
 The user can stow the mobile device.



It's recommended to label the utility by selecting the appropriate "Utility Type" in the receiver's menu.  
 On the receiver Select Menu Button  -  
 Select Utility Type press the  -  
 Select the appropriate utility type by pressing the  -  
 Once the appropriate utility is selected press the  button twice to return to the locate screen.



The user must press and hold the depth button to record a log point.

**Download Logs Method 1:**

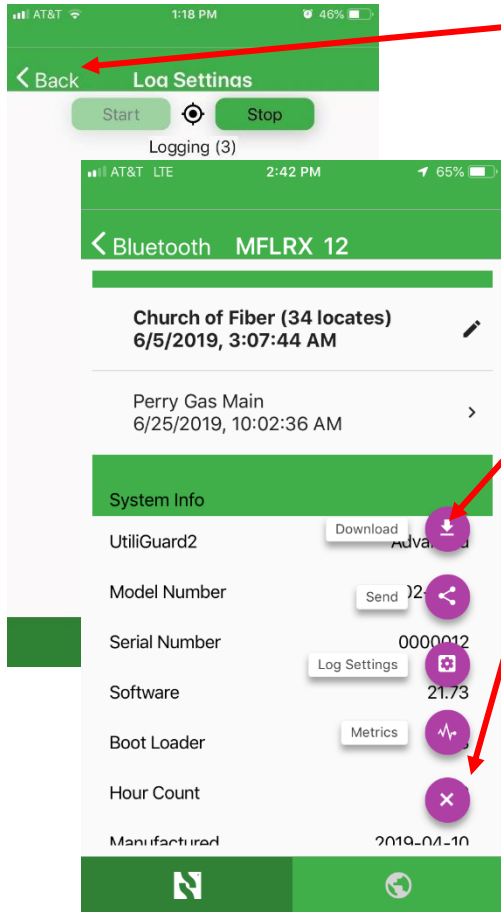

If the mobile device and the receiver are still Bluetooth connected, select "Back" to go to previous screen

Select action button  
Then select "Download"

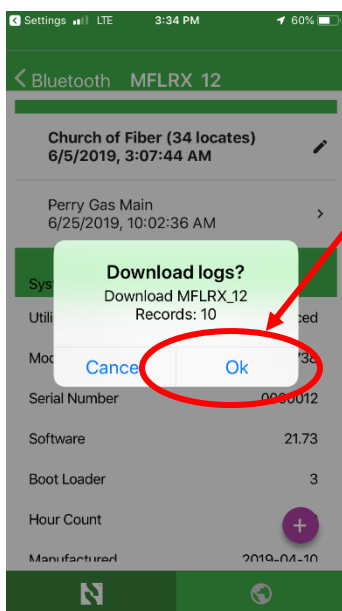

Log downloads to mobile device and user can select the job from the job list.

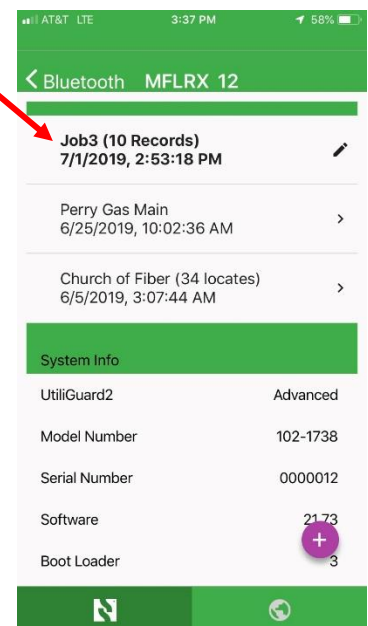

**Download Logs Method 2:**

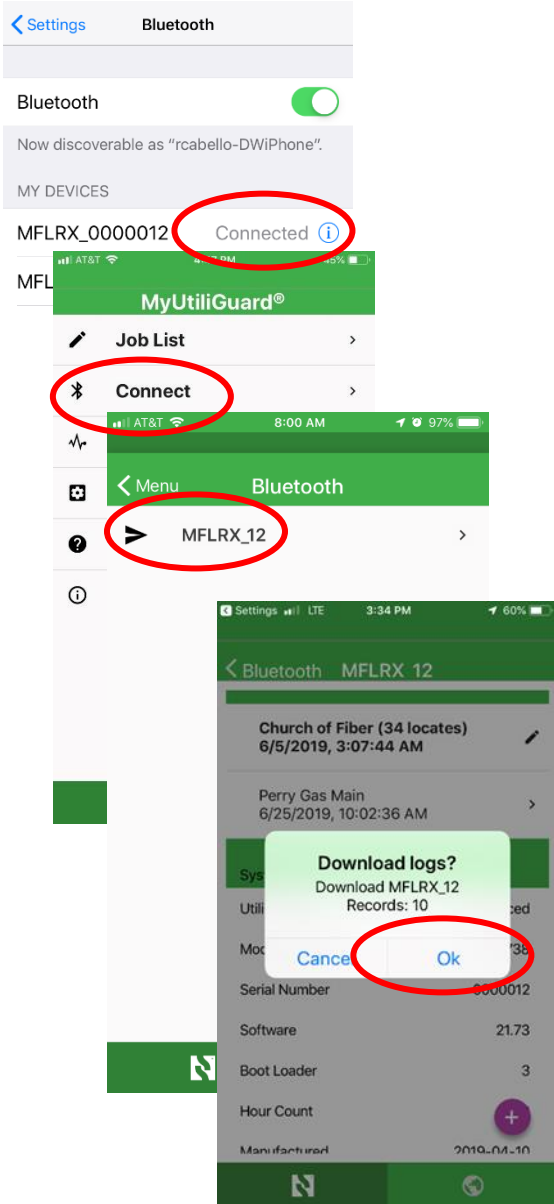

Bluetooth connect the mobile device to the receiver. Open the MyUtiliGuard app and download the log.

**Share log file:**

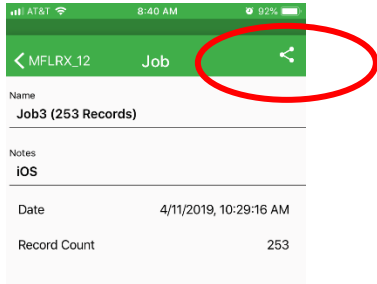

Job can be sent via email or opened via Google earth.

*If a GPS fix is not acquired a KML file will not generate.*

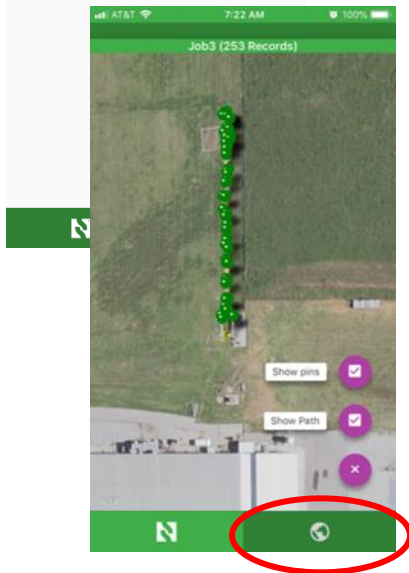

**Job List:**

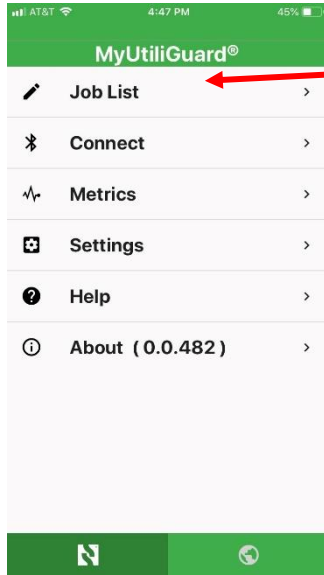

Jobs Downloaded from the UTG 2.0 RX are stored on the mobile device.

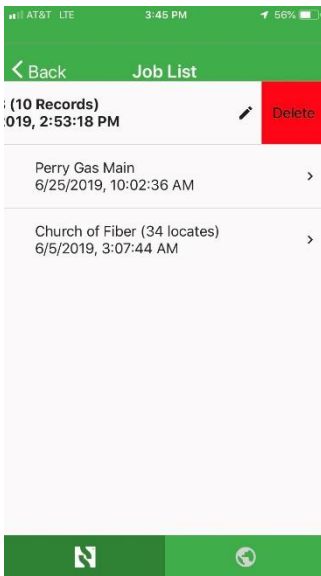
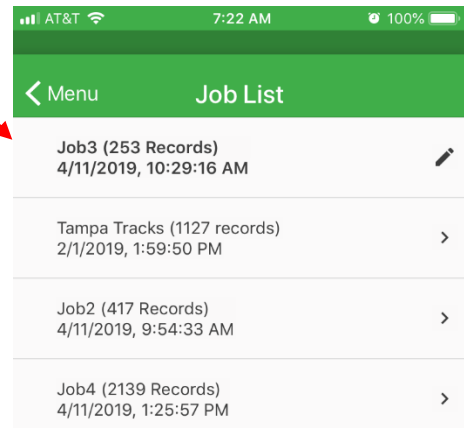

To delete a log file from the mobile device, Swipe left and select the delete button.

**Advanced logging**



The action button commands:

- Start/Stop logging
- Erase Logs
- Lock/Unlock Log settings
- Show Advanced "log settings"

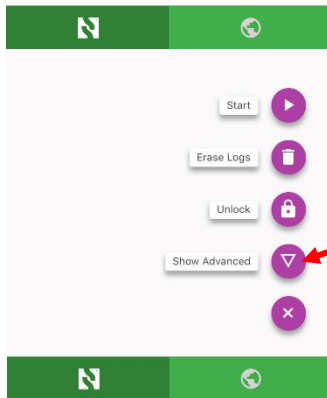

"Show Advanced" opens the field below

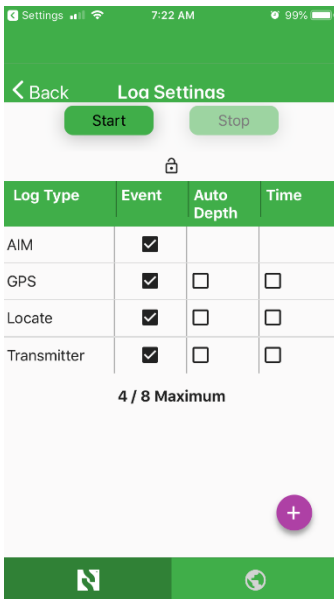

Start/Stop logging

Lock / Unlock log settings

Check all that apply (Advanced RX: maximum of 8 entries can be selected)

Once the user has established the log settings the locator can press on the "Start" button and begin to log the utility.

*Page Intentionally Left Blank*